

Pixsys Pressure Sensor

Safety standards

Carefully read the instructions and safety measures in this manual before using the device. Disconnect power before performing any interventions on the electrical connections or hardware settings. Only qualified personnel may use/perform maintenance in full respect of the technical data and declared environmental conditions. Do not dispose of electrical appliances together with household waste. In compliance with the European Directive 2002/96/EC, waste electrical equipment must be collected separately for eco-compatible reuse or recycling.

1 Technical specifications

Accuracy	± 0.3% F.S.
Operating temperature	- 25°C ... +85°C

Media temperature	ECT: - 25°C ... + 125°C
	ECT 400 bar / 5000 psi: - 10°C ... + 125°C

2 Ordering codes

Item code	Description	Item code	Description	Item code	Description	Item code	Description
2000.40.088	0...100 mbar	2000.40.122	-1.0...0 bar	2000.40.102	0...4 bar	2000.40.106	0...25 bar
2000.40.089	0...200 mbar	2000.40.119	-1.0...3 bar	2000.40.103	0...6 bar	2000.40.107	0...40 bar
2000.40.090	0...400 mbar	2000.40.100	0...1 bar	2000.40.104	0...10 bar	2000.40.108	0...100 bar
2000.40.091	0...600 mbar	2000.40.101	0...2.5 bar	2000.40.105	0...16 bar	2000.40.110	0...250 bar

3 Type label description (example 10 bar model)



1 2000.40.104

P0213999999999

2 0...10 bar PRESSURE TRANSM.
RELATIVE, - OUT 4...20 mA
G 1/4" - ACCURACY +/-0.3%
DIN 43650-A Pin2(+) Pin1(-)

MADE IN SWITZERLAND



1 Item code

2 Measuring range

3 Option description

4 Electrical connections

Output	Load resistance	I _{SUPPLY}	U _{SUPPLY}
4 ... 20 mA	(USupply-9V)/ 20mA		9 ... 30 VDC

Features	
Input Protection	IP65
Designation	Industrial Standard contact distance 9.4 mm
Type code	2000.40.XXX

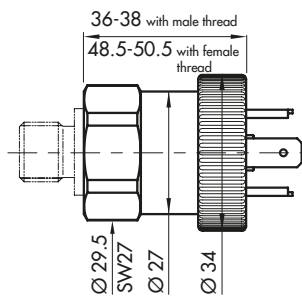
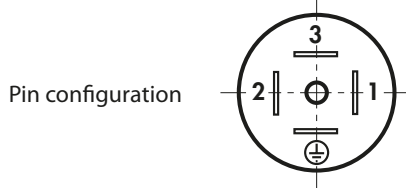

4.1 Pressure connection

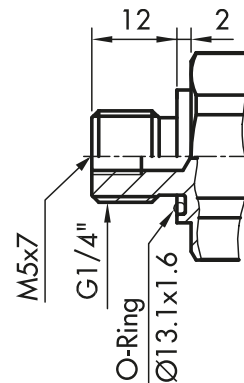

4.2 Connection of the measuring equipment

